

SI Rod end BEF1-1-21-501-DURBAL - BEF1-1-21-501-DURBAL

<https://www.123bearing.ie/bearing-housing/rod-end/si/bef1-1-21-501-durbal>

BEF1/1-21-501



rod end housing:
forged steel, tempered, surface galvanized, free of Cr VI

joint ball:
ball bearing steel, hardened and ground, surface superfinished and chromium plated

race:
nylon / teflon / glass fibre compound

tolerances:
see page 10

DURBAL® heavy-duty rod ends with integral spherical plain bearing

female thread:
maintenance free, dimensions in inches

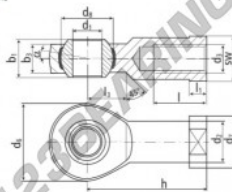

order number		measurements [inches]											
type	right hand thread	left hand thread	d ₁	d ₂	d ₃	class 2	d ₅	d ₇	d ₈	b ₁	b ₂		
BEF	1/1	-21	-501	1.000	1.319	1.0000-14	UNS	2.362	1.654	1.688	1.220	.866	
		measurements [inches]										weight	basic load rating
type	h	l	l ₁	l ₂	l ₃	SW	α ₁ [°]	α ₂ [°]	l _q	C ₁₀ [N]	C ₁₀ [N]		
BEF	1/1	3.720	1.653	.511	1.200	1.417	15.5	10.0	0.663	45350	118600		

PRODUCT FEATURES

Brand	DURBAL
N° Ean13	3663952510644
Inside diameter	25.4 mm
Outside diameter	59.99 mm
Thickness	30.99 mm
Type	SI
Weight	663 g
Thread	Right-hand thread
Lubrication	without
Packaging	1

contact@123bearing.ie

+33 359 36 04 90

CRT4 de Lesquin 60 Rue Du Haut De Sainghin 59273 Fretin FRANCE