

SI Rod end BEF22-20-502-DURBAL - BEF22-20-502-DURBAL

<https://www.123bearing.ie/bearing-housing/rod-end/si/bef22-20-502-durbal>

BEF22-20-502



rod end housing:
forged steel, tempered, surface galvanized, free of Cr VI

joint ball:
ball bearing steel, hardened and ground, surface superfinished and chromium plated

race:
nylon / teflon / glass fibre compound

tolerances:
see page 10

DURBAL® heavy-duty rod ends with integral spherical plain bearing

female thread:
maintenance free, adapter sizes according to DIN ISO 12240-4, series K, thread according to ISO 8139

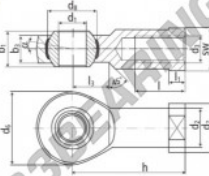

order number		measurements [mm]									
type	type	d1	d2	d3	d4	d5	d6	d7	d8	h	l1
BEF 22	-20	-502	22	30,0	M 22 x 1,5	54	38	38,05	28	20,0	
measurements [mm]		weight									
type	h	l	l1	l2	SW	α1°	α2°	weight		basic load rating	
BEF 22	84	37	12,0	26	32	15,5	10,0	0,520		38230 95600	

PRODUCT FEATURES

Brand	DURBAL
N° Ean13	3663952508221
Inside diameter	22 mm
Outside diameter	54 mm
Thickness	28 mm
Type	SI
Weight	520 g
Thread	Left-hand thread
Lubrication	without
Packaging	1

contact@123bearing.ie

+33 359 36 04 90

CRT4 de Lesquin 60 Rue Du Haut De Sainghin 59273 Fretin FRANCE