

## SI Rod end BEF20-20-501-DURBAL - BEF20-20-501-DURBAL

<https://www.123bearing.ie/bearing-housing/rod-end/si/bef20-20-501-durbal>

### BEF20-20-501



**rod end housing:**  
forged steel, tempered, surface galvanized, free of Cr VI

**joint ball:**  
ball bearing steel, hardened and ground, surface superfinished and chromium plated

**race:**  
nylon / teflon / glass fibre compound

**tolerances:**  
see page 10

**DURBAL® heavy-duty rod ends with integral spherical plain bearing**

**female thread:**  
maintenance free, adapter sizes according to DIN ISO 12240-4, series K, thread according to ISO 8139

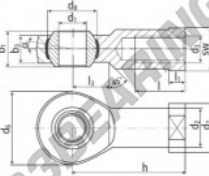

order number		measurements [mm]										weight	basic load rating	
type	right-hand thread, left-hand thread	d <sub>1</sub>	d <sub>2</sub>	d <sub>3</sub>	d <sub>4</sub>	d <sub>5</sub>	d <sub>6</sub>	d <sub>7</sub>	d <sub>8</sub>	b <sub>1</sub>	b <sub>2</sub>		dyn. C	stat. C <sub>0</sub>
BEF 20	-20 -501	20	27,5	M 20 x 1,5	50	34	34,87	25	18,0					
measurements [mm]		h	l	l <sub>1</sub>	l <sub>2</sub>	SW	α <sub>1</sub> <sup>1</sup>	α <sub>2</sub> <sup>2</sup>						
BEF 20		77	33	10,0	26	30	14,5	9,0	0,386	30805	82200			

## PRODUCT FEATURES

Brand	DURBAL
N° Ean13	3663952508207
Inside diameter	20 mm
Outside diameter	50 mm
Thickness	25 mm
Type	SI
Weight	386 g
Thread	Right-hand thread
Lubrication	without
Packaging	1

[contact@123bearing.ie](mailto:contact@123bearing.ie)

+33 359 36 04 90

CRT4 de Lesquin 60 Rue Du Haut De Sainghin 59273 Fretin FRANCE