

TPN Rod end
GK15-DO-DURBAL - GK15-DO-DURBAL
<https://www.123bearing.ie/bearing-housing/rod-end/tpn/gk15-do-durbal>

GK15-DO



Description: DIN ISO Hydraulic rod end with welding slope and dowel pin at the end of rod. Made of spherical plain bearing DGE... ES (ES-2RS) pressed into rod end housing. Sliding combination steel / steel.
Type DGK...DO-2RS with two additional seals available on request with grease nipple.

hydraulic rod ends, according to DIN ISO 12240-4, series E

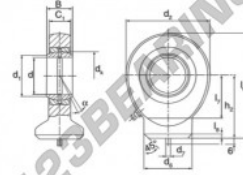

Sliding combination: steel / steel
Inner ring: bearing steel, hardened, ground and phosphated
Outer ring: bearing steel, hardened, ground and phosphated
Lubrication: lubrication required

* without grease nipple
** with grease nipple

order number	d	d ₁	d ₂	measurement [mm]			B	C ₁
GK 15 DO**	15	18,4	40	4	21,0	12	10	

type	h ₁	l ₁	measurement [mm]		D	d ₁	α	load rating	weight
			l ₁	l ₂			[°]	C ₀ [kN]	[kg]
GK 15 DO**	31	51,0	20,0	2,0	26	22,0	8	32,0	0,120

PRODUCT FEATURES

Brand	DURBAL
N° Ean13	3663952501321
Inside diameter	15 mm
Outside diameter	40 mm
Thickness	12 mm
Type	TPN
Weight	120 g
Lubrication	with
Packaging	1
Standard	No standard

contact@123bearing.ie

+33 359 36 04 90

CRT4 de Lesquin 60 Rue Du Haut De Sainghin 59273 Fretin FRANCE